



MOUNTING INSTRUCTIONS

2321-0072 FATS/SLIMS DETACHABLE MOUNTING KIT YAMAHA V-STAR CLASSIC 650/1100

! WARNING

Read and follow these directions carefully. During installation, make sure that the windshield and hardware do not interfere with any cables or wiring when the forks are turned all the way in either direction. Also make sure, through the full range of adjustment, that the windshield and hardware do not hit the tank.

This is a detachable windshield, **ALWAYS** make sure the Locking Mechanism is Fully Engaged after installing the windshield! The improper installation of this kit and related components could result in serious injury or death.

CAUTION

6. Adjust the height, angle and alignment of the windshield and tighten **ALL** bolts.

Note: This is a detachable windshield, **ALWAYS** make sure the Locking Mechanism is Fully Engaged after installing the windshield! (see figure 5)

IMPORTANT CARE AND CLEANING INSTRUCTIONS

Memphis Shades Windshields and Lowers are made of Lucite® acrylic, and will last for years with proper care. Clean your windshield with plenty of soapy water (mild dish-washing liquid is best) and a soft cotton cloth. Use your bare hand to feel and dislodge bugs, or cover with a wet soapy towel and let it soak. Don't use paper towels and don't scrape with anything. Small scratches can be removed with NOVUS # 2.

NEVER use any glass cleaning products, petroleum based chemicals, or cleaning agents with ammonia, bleach or any other harsh chemicals. This includes (but not limited to) RainX, brake fluid, acetone, paint thinner, benzene and gasoline. "If it hurts your nose, it will hurt the plastic."

Glass cleansing agents will cause severe damage to your windshield, and will void your warranty.

NOTE: At certain times of the day the Sunlight can reflect off the curvature of a windshield and cause extreme heat build-up on motorcycle instruments and instrument panel. Take care when parking. Park facing the sun, place an opaque object over the instruments or adjust the windshield to avoid reflections.

Additional tools required that are not included in this kit. 7/16" or 11mm Wrench.

1. Cover gas tank and front fender with towels to avoid damage during installation.

2. Install the two mounting plates onto the windshield, using the bottom and third bolt up. Leave the nylon washers off. The small tab goes to the bottom, big one at the top. *Tabs point in towards the headlight.* (see fig. 1)

3. There is an upper clamp and a lower clamp for each fork, (fig.2-A). The lower clamp has protective film on the inside and does not have the slotted bushing adjustment. The upper clamp has a flexible tapered Santoprene insert and does have the slotted bushing adjustment.

4. On the clutch side, install the lower clamp around the fork tin with the clamp in the largest setting as shown in figure 2-A. With the grooves in the polymer bushing facing directly forward, slide the clamp down until it rests on the lower triple tree and snug it in place.

Next, separate the tapered insert from the upper clamp and flex the insert around the upper part of the fork tin with the raised "stopper" portion up. Rotate the insert rearward until the raised "stopper" portion is underneath the upper triple tree, with the trailing edge of the "stopper" portion even with the edge of the upper triple tree.

Around the fork tin, slide the two parts of the upper clamp together in the smallest setting, and slip the clamp over the Santoprene insert, and align it with the lower clamp as shown in figure 2-B. (The cable guide may need to be bent slightly.)

Repeat Step 4. on the throttle side.

5. Slip the windshield mounting plates and windshield onto the fork clamps, (see figure 3 and 5) and secure the left and right side locking mechanism.

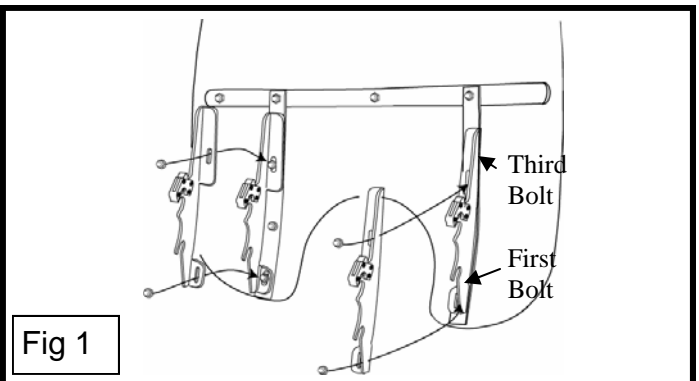
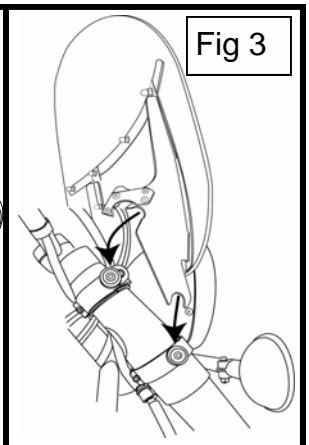
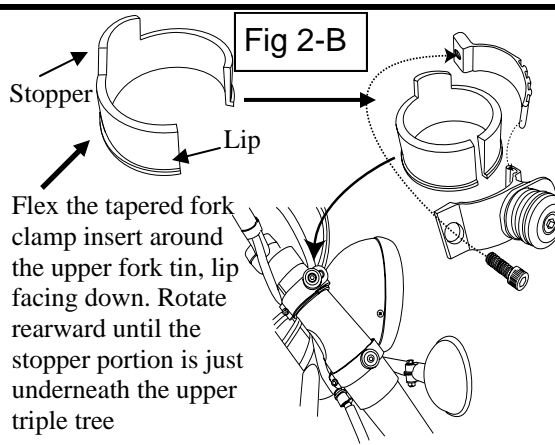
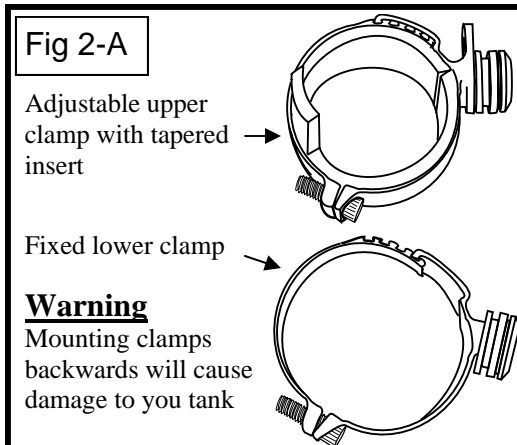

Fig 1





MOUNTING INSTRUCTIONS

2321-0072 FATS/SLIMS DETACHABLE MOUNTING KIT YAMAHA V-STAR CLASSIC 650/1100

Part #	Description	Qty
M8980	Mounting Instructions	1
M1185	Left Mounting Plate, Fats / Slims	1
M1184	Right Mounting Plate, Fats / Slims	1
R323	Bushing Assembly (2 part)	4
R324	#207 EPDM O Ring	4
R318	1" Socket Shoulder Washer	2
M306	1/4-20x5/8" Socket Head Cap Screw	2
R329	Slot Nut	2
M369	Stainless Steel Washer	2
R347	Santoprene Tapered Fork Clamp Insert	2
R322C	Clutch Side Latch Assembly	1
R322T	Throttle Side Latch Assembly	1

Part #	Description	Qty
R334	6-32x3/8" Flat Head SS Screw	8
R326	SS Spring	2
R346	1" Short Socket Shoulder Washer	2
FC915	Inner Adjustable Fork Clamp Half	4
R534	Outer Non-adjustable Large Fork Clamp	2
FC916	Outer Detachable Adjustable Fork Clamp Half	2
M302	1/4-20x1/2" Socket Head Cap Screw	2
R331	1/4-20x7/8" Socket Head Cap Screw	4
M310	3/16" Short Arm Allen Wrench	1
M313	3/16" Allen Wrench Cover	1

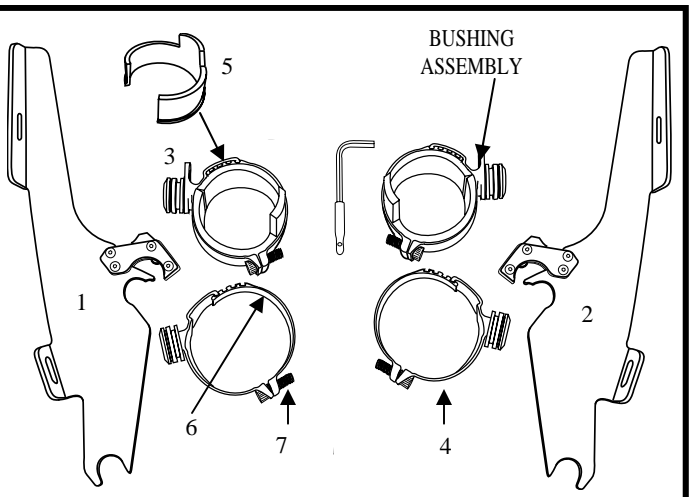
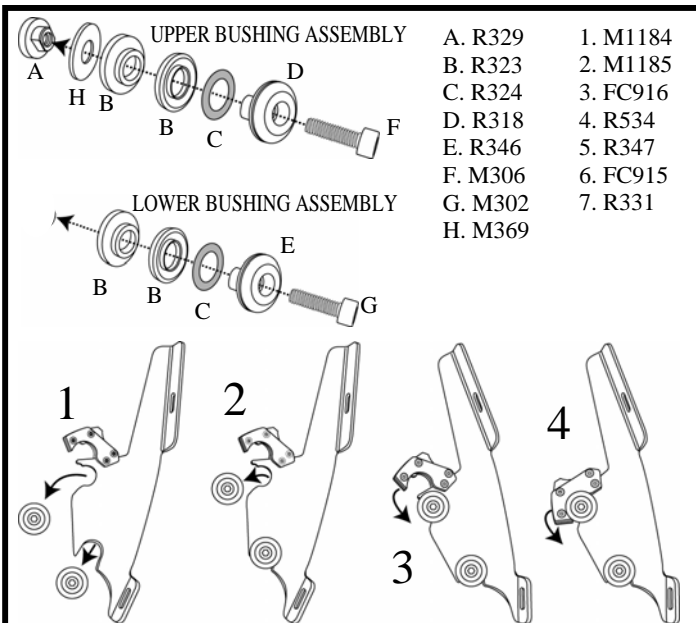

2321-0072 FATS/SLIMS KIT

1. Place lower slot into lower bushing. 2. Rotate top slot into place. 3. & 4. Secure locking Mechanism.

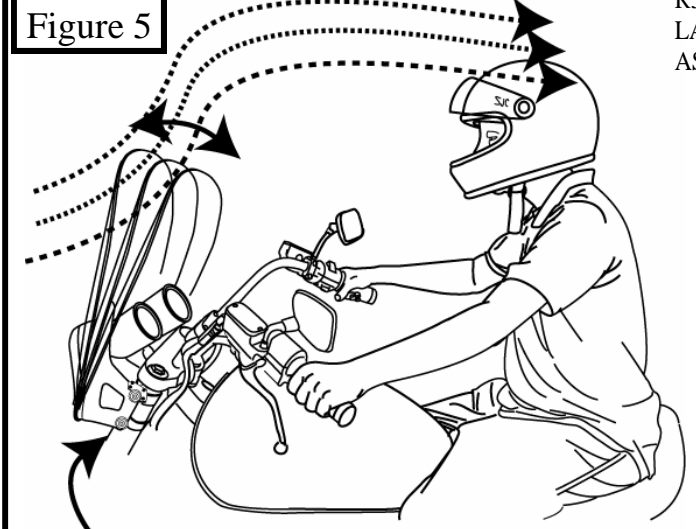

Loosen Allen Bolt to adjust angle, then re-tighten Allen Bolt.

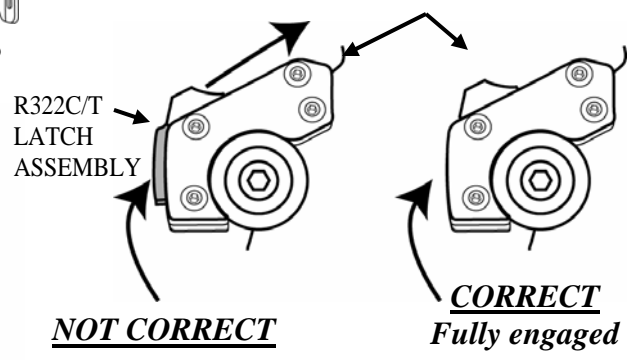

Memphis Shades warrants all product components, metal and plastic, against defects in materials and workmanship for 24 months.

FOR PARTS AND WARRANTY HELP, CONTACT:
 MEMPHIS SHADES
 P. O. Box 429
 Rossville, TN 38066
 (901) 853-0293
 Visit us on the web at www.memphisshades.com or
 You can also reach us by email:
customerservice@memphisshades.com